

Arkitekt Single lever

abode

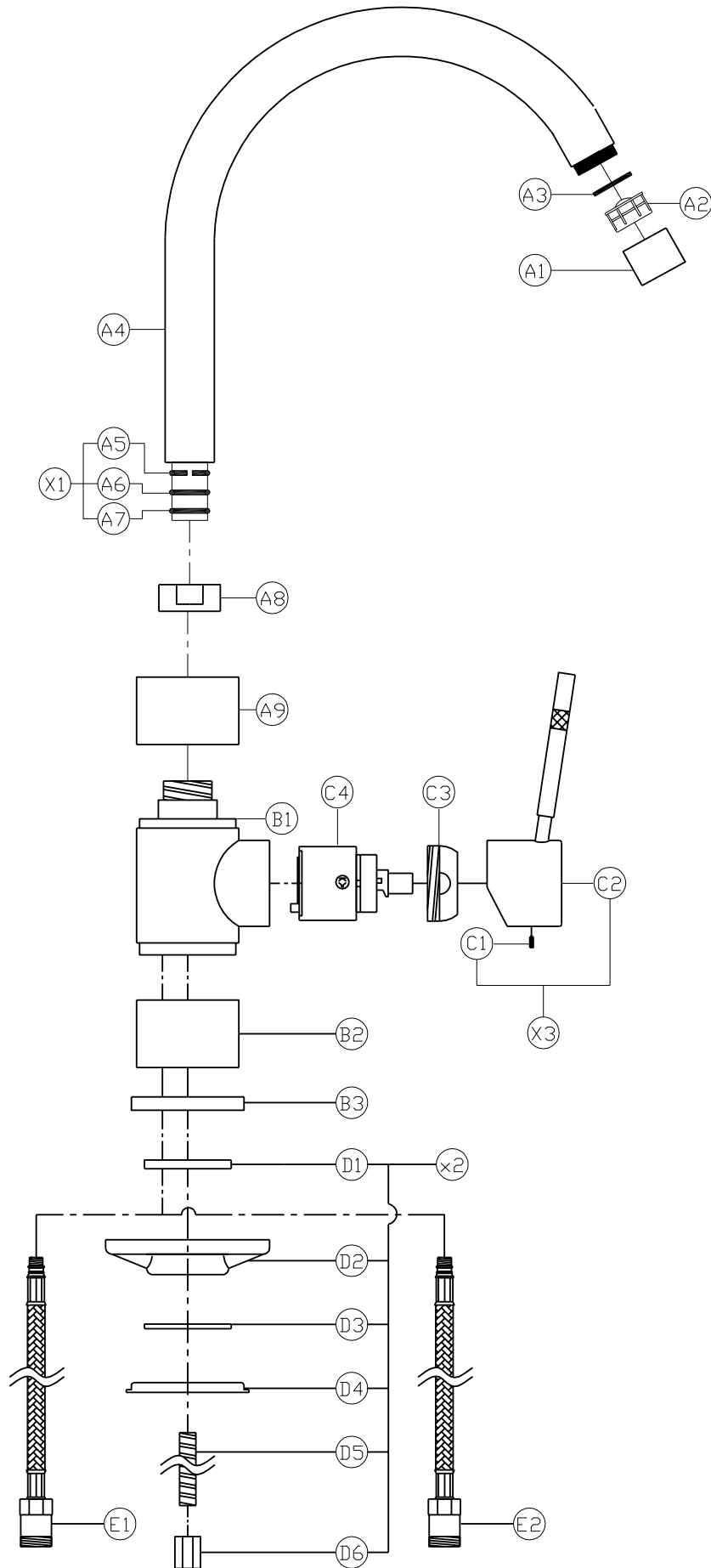

Arkitekt single lever

abode

General Advice:

- These instructions are intended as a guide only, if you are in any doubt you should seek the advice of a qualified professional.
- Take care not to mark finished parts with screwdrivers or other tools.
- Use a pair of rubber gloves to get a better grip on decorative hand tight parts.
- Ensure all parts are reassembled tightly.
- After maintenance test that all assemblies are water tight and function correctly.
- Always isolate the hot and cold water supplies before starting any maintenance, once isolated you should drain any residual water from your system.

To replace the valve:

1. Tilt the handle (C2) into the on position.
2. Loosen grub screw (C1) using a 2mm A/F Allen key.
3. Pull the handle (C2) horizontally away from the tap.
4. Hold the body of the tap (B1) firmly. Using an adjustable spanner unscrew the valve lock nut (C3).
5. Pull the old valve cartridge (C4) away from the tap.
6. Ensure that the valve chamber (B1) is clean of dirt and grit.
7. Place the new valve (C4) in the chamber (B1), ensuring the locators on the base of valve (C4) align with the recesses in the chamber of the tap (B1).
8. Reassemble the tap in the reverse order.

To replace the spout o-rings:

1. Slide the spout decorative cover (A9) up the spout (A4) to expose the spout locking collar.
2. Using an adjustable spanner, loosen off the spout locking collar (A8) and pull the spout (A4) vertically away from the body (B1). Note that the locking collar (A8) is attached to the spout by the PTFE spacer (A5).
3. Remove the old o-rings (A6 & A7) using a small screwdriver or similar.
4. If worn, remove the white PTFE spacer (A5).
5. Ensure the inside of the body (B1) and the spout base (A4) is clean of dirt and grit.
6. If required locate the new white PTFE spacer (A5).
7. Carefully locate the new O-rings (A6 & A7) onto the spout (A4).
8. Grease the O-rings thoroughly with silicone or alternative similar grease.
9. Reassemble the tap in the reverse order.